



3M™ Speedglas™ Welding Helmet 9100XXi FX Air

To optimise the effective lifetime of your welding equipment and avoid the additional cost of replacement, regular maintenance is important. Replace all damaged parts immediately to ensure correct levels of protection. Below is a helpful overview; always read and follow user instructions.



Before use

- Helmet and head harness.** Inspect for cracks or any damaged parts. Replace if needed.
- Cover lenses and visor.** To provide the best possible vision, they should be clean and without scratches.
- Face seal.** If the face seal is damaged there is a great risk that contaminated air will get inside the helmet. Verify it's in position and free from splits and tears.
- Welding filter.** Ensure that the low battery indicator is not flashing and check that the sensors are clean and uncovered.
- Breathing tube.** Confirm that the tube is not damaged or leaking any air. To extend the life of the breathing tube, use a tube cover or a heavy-duty breathing tube.

After use

- Clean the helmet.** Wipe with a moist tissue or cloth, both inside and outside the helmet. If you suspect that the inside of the breathing tube is dirty, it must be changed. DO NOT rinse, immerse in water or clean with solvents.
- Face seal and sweatband.** Remove for additional cleaning as needed and replace if they have splits or tears or whenever they become unhygienic.
- Cover lenses and visor.** Clean with a soft cloth and replace if any pits or scratches occur.
- Breathing tube.** Replace if damaged, deformed or leaking any air.
- Storage.** Store the helmet in a dry, clean area away from direct sunlight, high temperatures and solvents.

Spare parts and consumables

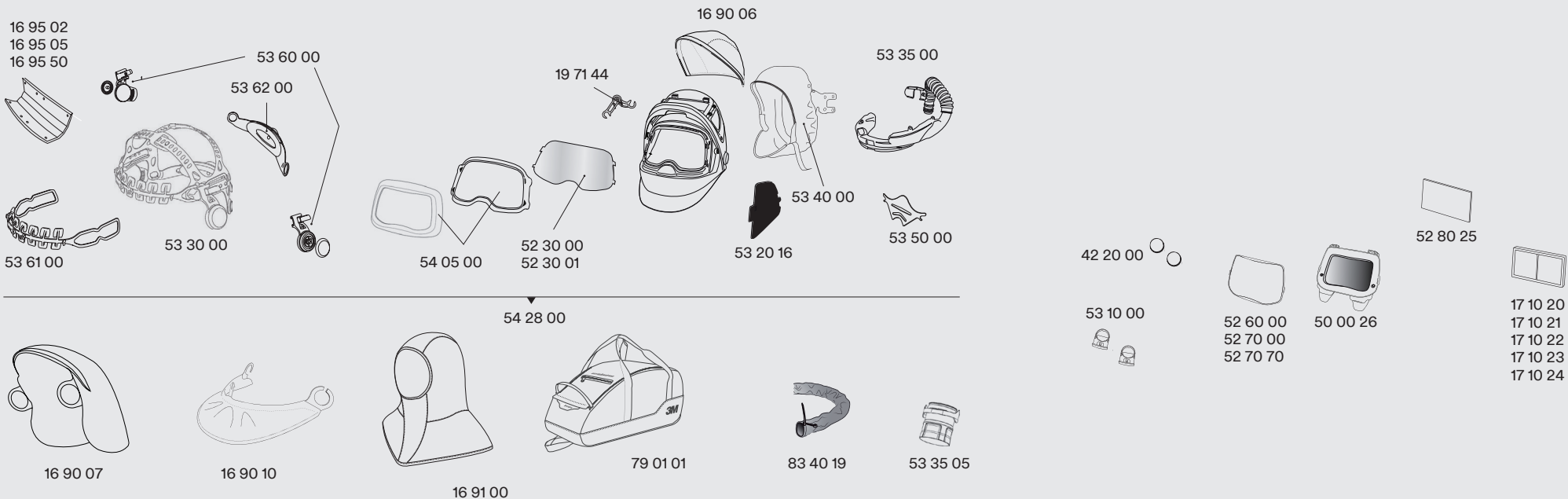

Part No	Description	Part No	Description	Part No	Description
16 90 06	Head Cover Small 9100 FX	52 30 00	Visor Plate 9100 FX & MP Pk=5	53 61 00	Head Harness Front Part 9100
16 90 07	Head Cover Large 9100 FX	52 30 01	Visor Plate Anti-Fog 9100 FX & MP Pk=5	53 62 00	Head Harness Back Part 9100
16 90 10	Throat Protection 9100	52 60 00	Lens Cover Outer Standard 9100 Pk=10	54 05 00	Front Cover Kit 9100 FX & MP
16 91 00	Head Cape Tecaweld	52 70 00	Lens Cover Outer Hard Coated 9100 Pk=10	54 28 00	Helmet Welding 9100 FX Air Exc Lens
16 95 02	Sweatband 9100 & 9100 FX Pk=2	52 70 70	Lens Cover Outer High Heat 9100 Pk=10	79 01 01	Carry Bag Speedglas
16 95 05	Sweatband 9100 & 9100 FX Pk=5	52 80 25	Lens Cover Inner 9100XX/XXi Pk=5	83 40 19	Breathing Tube Cover Flame Resistant 9100 FX Air
16 95 50	Sweatband 9100 & 9100 FX Pk=50	53 10 00	Holder Battery 9100		
17 10 20	Lens Magnifying 1.0X 9100, 100 & 9000	53 20 16	SideWindows Cover Plate 9100 FX & MP Pk=2		
17 10 21	Lens Magnifying 1.5X 9100, 100 & 9000	53 30 00	Head Harness 9100		
17 10 22	Lens Magnifying 2.0X 9100, 100 & 9000	53 35 00	Air Duct Assembly 9100 FX Air		
17 10 23	Lens Magnifying 2.5X 9100, 100 & 9000	53 35 05	Adaptor Adflo Breathing Tube 9100 Air, FX Air & MP Air		
17 10 24	Lens Magnifying 3.0X 9100, 100 & 9000	53 40 00	Face Seal 9100 FX Air		
19 71 44	Flip Up Mechanism 9100 FX Pk=2	53 50 00	Air Deflector 9100 FX Air		
42 20 00	Battery Lithium 9100, 100 & 9000 Pk=2	53 60 00	Head Harness Pivot Mechanism 9100		
50 00 26	Lens Welding 9100XXi Speedglas				



Speedglas™
Welding Safety

3M™ Adflo™ Powered Air Respirator



To optimise the effective lifetime of your welding equipment and avoid the additional cost of replacement, regular maintenance is important. Replace all damaged parts immediately to ensure correct levels of protection.

Before use

- Battery.** Ensure that it's adequately charged and fitted correctly.
- Motor body.** Inspect the unit for damage and ensure it's firmly fixed to the belt. Ensure filters are correctly fitted.
- Breathing tube.** Inspect the tube and connections to ensure they are free from splits and holes. Replace if damaged, deformed or leaking any air. To extend the life of the breathing tube, use a tube cover or the heavy-duty rubber breathing tube.
- Air flow check.** Fit the breathing tube to the unit and attach the airflow meter in the other end of the tube and switch on the Adflo PAPR. If the ball does not rise above the line, continue fault finding.
- Alarm check.** Cover the air outlet of the airflow meter with your hand until an audible warning is heard and the red indicator illuminates. Remove your hand. The alarm should now stop.

After use

- Clean the equipment.** Wipe the motor body with a moist tissue or cloth. If you suspect that the inside of the breathing tube is dirty, it must be changed. DO NOT rinse, immerse in water or clean with solvents. DO NOT attempt to remove contamination of filters as this will damage the filters and void the warranty.
- Replace damaged parts.** Replace all damaged parts to guarantee the proper functioning of the respirator. Worn out components should be disposed of according to local regulations.
- Spark arrestor.** Replace if deformed and no longer fitting well.
- Pre-filter.** Replace regularly to extend the life of the particle filter. This will save money and also extend the battery run-time.
- Particle filter.** Check the filter indicator position and replace if the red LED is lit. Otherwise, replace whenever the battery operating time becomes too short, or when "fully loaded" filter triggers low airflow alarm.
- Gas filter.** Replace the gas filter according to your work place requirements. Do not wait until you can smell odours.
- Odour filter.** Replace any time you smell unpleasant odours. Odour filter is not required if gas filter is used.
- Storage.** Put the battery/turbo unit on charge after use. When stored, recharge every six months. Store the unit in a dry, clean area away from direct sunlight, high temperatures and solvents. For example use the Adflo storage bag.

Spare parts and consumables

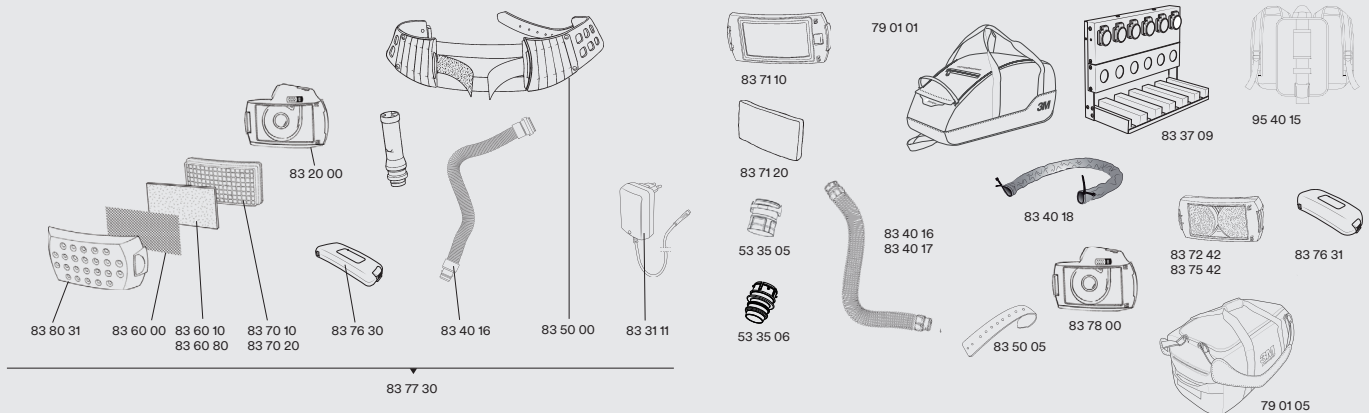

Part No	Description	Part No	Description	Part No	Description
53 35 05	Adaptor Adflo Breathing Tube 9100 Air, FX Air, MP Air	83 50 05	Belt Extension Adflo	83 76 30C	Upgrade Kit Standard Li-ion Battery & Charger
53 35 06	Adaptor QRS Breathing Tube to 9000	83 60 00	Spark Arrestor Adflo	83 76 31*	Battery Heavy Duty Li-ion Adflo
79 01 01	Carry Bag Speedglas	83 60 10	Pre-Filter Adflo Pk=5	83 76 31C	Upgrade Kit Heavy Duty Li-ion Battery & Charger
79 01 05	Carry Bag Speedglas Heavy Duty	83 60 80	Pre-Filter Adflo Pk=80	83 77 30	Respirator Standard Li-ion Adflo
83 20 00	PAPR Motor with Housing Adflo	83 70 10	Filter Particle PSL Adflo Pk=20	83 77 31	Respirator Heavy Duty Li-ion Adflo
83 31 11*	Charger Battery Li-ion Adflo	83 70 20	Filter Particle PSL Adflo Pk=80	83 78 00	PAPR Motor with Housing Adflo High Altitude
83 37 09	Battery Multi-Station Adflo	83 71 10	Filter Odour Adflo	83 80 31	Filter Cover Li-ion Adflo
83 40 16	Tube Breathing Self Adjusting QRS Adflo	83 71 20	Filter Odour Replacement Pad Adflo	95 40 15	Backpack Adflo
83 40 17	Tube Breathing Heavy Duty Rubber QRS Adflo	83 72 42	Filter Nuis Level Organic Vapour/Acid Gas Adflo		
83 40 18	Tube Breathing Cover Flame Resistant Adflo	83 75 42	Filter Gas A1 Adflo		
83 50 00	Belt Adflo	83 76 30 [†]	Battery Standard Li-ion Adflo		

[†] Lithium-ion (grey) batteries (83 76 30, 83 76 31) are only compatible with the Lithium-ion battery charger (83 3111).

www.aws.com.au

[facebook.com/awsspeedglas](https://www.facebook.com/awsspeedglas)

[instagram.com/3MSpeedglas](https://www.instagram.com/3MSpeedglas)

[youtube.com/awsspeedglas](https://www.youtube.com/awsspeedglas)



Australian Welding Supplies Pty Ltd
PO Box 912 • Artarmon NSW 1570 • Australia
T: (02) 9439 0111 • F: (02) 9439 0100
E: sales@aws.com.au
W: www.aws.com.au

Authorised Wholesaler



Speedglas™
Welding Safety

Further information and advice

To request a quote or place an order for spare parts, please contact AWS on +61 (0) 2 9439 0111 or visit www.aws.com.au. Please note that higher than normal levels of pollutants, heat and sparks will require more frequent replacement of components. If you require additional guidance, please check the care and maintenance videos on our YouTube channel (www.youtube.com/awsspeedglas) or contact your local AWS representative.